

Blaenau Gwent CBC Planning Control / Rhoeli Cynllunio CBS Blaenau Gwent

General Offices
Steelworks Road
Tyllwyn, Ebbw Vale, NP23 6AA.
Tel: 01495 355555 Fax: 01495 355598
Email: planning@blaenau-gwent.gov.uk

Swyddfeydd Cyffredinol
Heol Gwaith Dur
Tŷ Llwyn, Glyn Ebwy, NP23 6AA.
Ffon: 01495 355555 Ffacs: 01495 355598
E-bost: planning@blaenau-gwent.gov.uk



www.blaenau-gwent.gov.uk

Application for Removal or Variation of a Condition following Grant of Planning Permission
Town and Country Planning Act 1990; Planning (Listed Buildings and Conservation Areas) Act
1990

Publication of applications on planning authority websites

Please note that the information provided on this application form and in supporting documents may be published on the Authority's website. If you require any further clarification, please contact the Authority's planning department.

Site Details

If you cannot provide a postcode, the description of site location must be completed. Please provide the most accurate site description you can, to help locate the site - for example "field to the North of the Post Office".

Number

Suffix

Property Name

Address Line 1

Address Line 2

Town/city

Postcode

Description of site location (must be completed if postcode is not known)

Easting (x)

Northing (y)

Description

Applicant Details

Name/Company

Title

Mr

First name

Anthony

Surname

Davies

Company Name

Address

Address line 1

60 Beaufort Street

Address line 2

Address line 3

Town/City

Brynmawr

Country

Postcode

NP23 4AE

Are you an agent acting on behalf of the applicant?

Yes

No

Contact Details

Primary number

Secondary number

Email address

Agent Details

Name/Company

Title

mr

First name

Stephen

Surname

Traves

Company Name

Address

Address line 1

4 Rotherwas Close

Address line 2

Address line 3

Town/City

Hereford

Country

United Kingdom

Postcode

HR2 6RG

Contact Details

Primary number

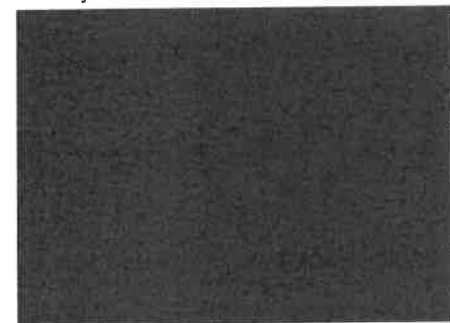

Description of the Proposal

Please provide a description of the approved development as shown on the decision letter

Development of 6 housing units. Mixture of semi-detached and terrace at land at Oak Road, Tanglewood, Blaina.

Reference number

C/2019/0025

Date of decision (date must be pre-application submission)

10/04/2019

Please state the condition number(s) to which this application relates

Condition number(s)

9

Has the development already started?

- Yes
 No

Condition(s) - Removal

Please state why you wish the condition(s) to be removed or changed

The application approval expires on 10/04/2024. Due to covid19, a start on site has been delayed. We wish to extend this date.

If you wish the existing condition to be changed, please state how you wish the condition to be varied

Extend the application expiry date by 5 years.

Site Visit

Can the site be seen from a public road, public footpath, bridleway or other public land?

- Yes
 No

If the planning authority needs to make an appointment to carry out a site visit, whom should they contact? (Please select only one)

- The agent
 The applicant
 Other person

Pre-application Advice

Has pre-application advice been sought from the local planning authority about this application?

- Yes
 No

Ownership Certificates

Town and Country Planning (Development Management Procedure) (Wales) Order 2012

Please answer the following questions to determine which Certificate of Ownership you need to complete: A,B,C or D.

Are you the sole owner of ALL the land?

- Yes
 No

Certificate of Ownership - Certificate A

I certify/the applicant certifies that on the day 21 days before the date of this application nobody except myself/the applicant was the owner (owner is a person with a freehold interest or leasehold interest with at least seven years left to run) of any part of the land or building to which the application relates.

Person Role

- The Applicant
 The Agent

Title

Declaration made

Agricultural Holding Certificate

Town and Country Planning (Development Management Procedure) (Wales) Order 2012

Agricultural land declaration - you must select either A or B

- (A) None of the land to which the application relates is, or is part of an agricultural holding
 (B) I have/The applicant has given the requisite notice to every person other than myself/the applicant who, on the day 21 days before the date of this application, was a tenant of an agricultural holding on all or part of the land to which this application relates, as listed below

Person Role

- The Applicant
 The Agent

Title

Declaration Date

Declaration made

Declaration

I/We hereby apply for Removal/Variation of a condition as described in the questions answered, details provided, and the accompanying plans/drawings and additional information.

I/We confirm that, to the best of my/our knowledge, any facts stated are true and accurate and any opinions given are the genuine opinions of the person(s) giving them.

I/We also accept that:

- Once submitted, this information will be made available to the Local Planning Authority and, once validated by them, be made available as part of a public register and on the authority's website;
- Our system will automatically generate and send you emails in regard to the submission of this application.

I / We agree to the outlined declaration

Signed

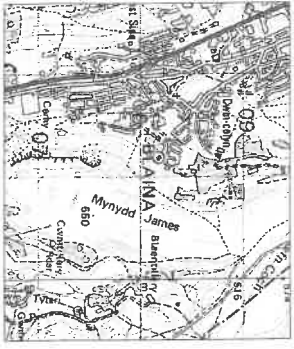
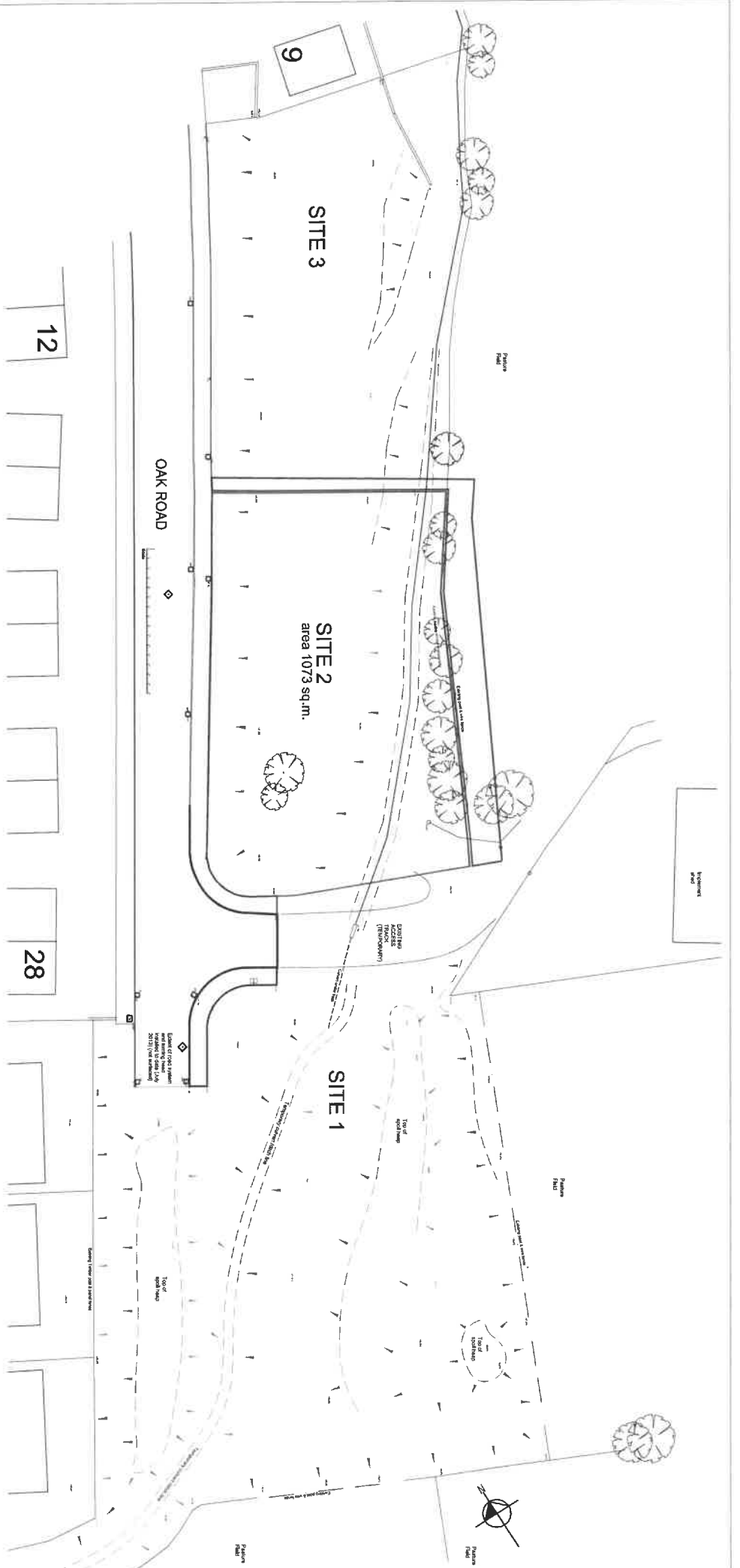

Location 1:2500



Aerial view - NTS

PREPARED BY: Simply Welsh Developments Ltd.			
PROJECT: 23 - 29b Oak Road (Site 2) Bangor-on-Dee Blaina			
DATE: 13-02-14			
SCALE: 1:250			
PROJECT NO.: 13-021-PL-01			

Clerk

Item no 3a

From: 
Sent: 06 April 2024 19:03
To: Clerk
Subject: Farm Road , Nantyglo

Good evening,

I would like to raise my and my wife's concerns over the increase in speeding vehicles travelling along Farm Road to the point there is going to be a serious accident, having seen a recent near miss when a car was trying to exit the Trevor Rowson Park and a speeding vehicle travelling along Farm Road. Farm Road seems to be being used as an alternative route to using Queen Street/King Street , this is also very noticeable at school times.

This road is used by lots of pedestrians including children and it is only a matter of time before someone is serious hurt

Would it be possible to look into some form of traffic calming along the whole length of Farm Road to attempt to slow traffic down,

Thanks 

Sent from [Outlook for Android](#)